

PL32, PL33

Montage- und Bedienanleitung

*Assembly and operating instructions
Notice de montage et mode d'emploi*

PL32

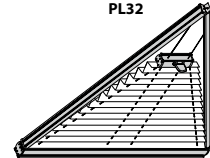

PL33

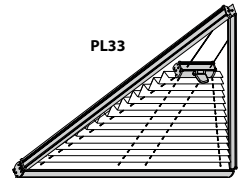

10 / 2014

technische Änderungen bleiben
vorbehalten

*subject to technical change
sous réserve de modifications techniques*



04046046223924

→ Bitte nur beiliegende Schrauben verwenden!
Please use only the enclosed screws! - Veuillez utiliser seulement les vis jointes!

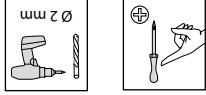

DECKENCLIP
CEILING CLIP - CLIP PLAFOND

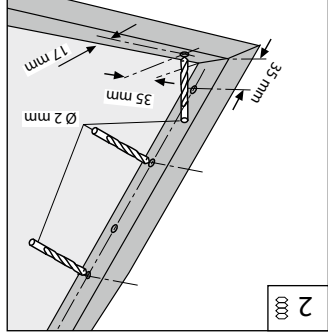
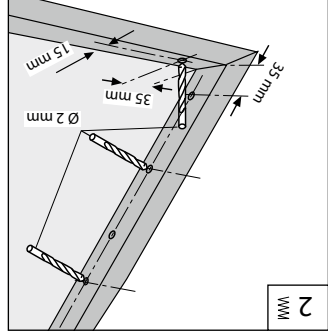
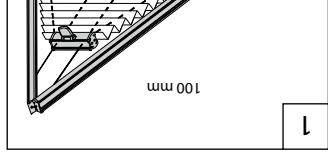
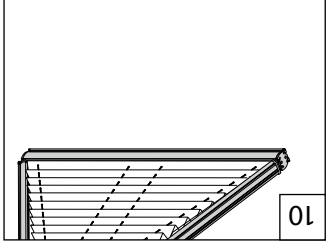
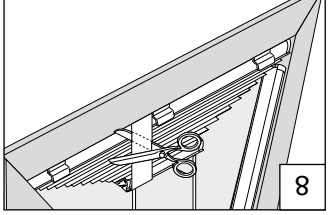
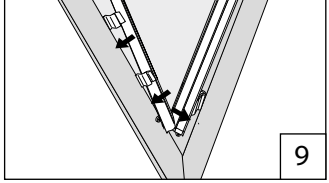
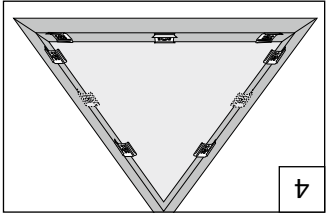
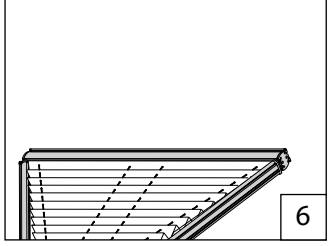
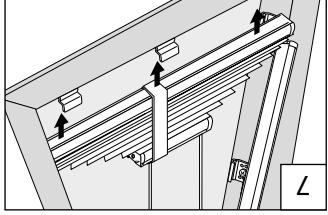
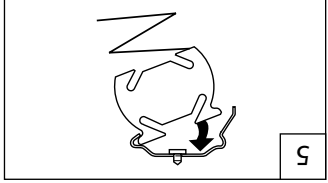
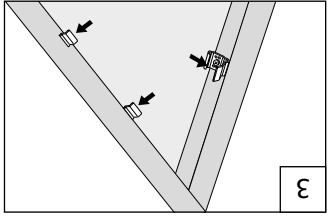

1

2

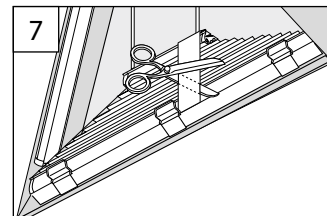
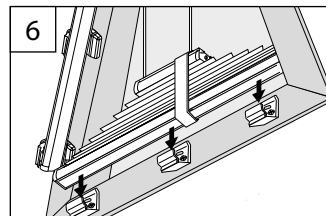
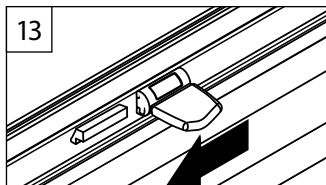
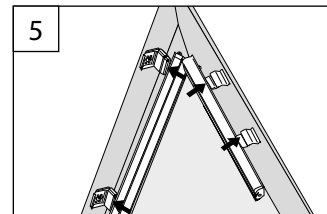
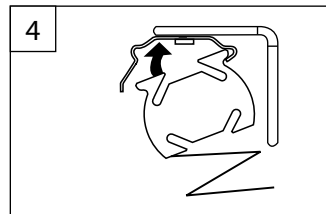
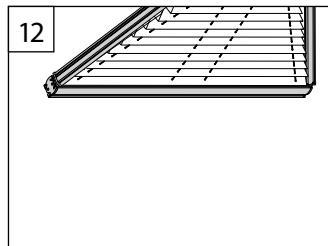
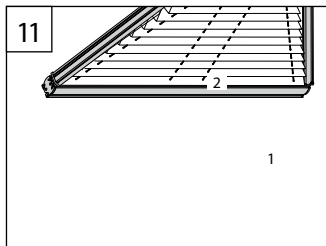

DECKENCLIP / WANDWINKEL

CEILING CLIP / WALL FIXING BRACKET - CLIP PLAFOND / SUPPORT MURAL

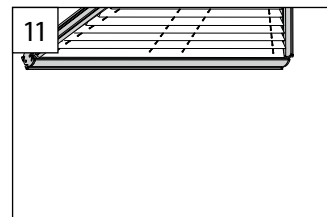
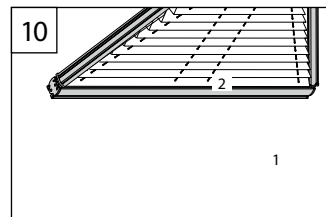
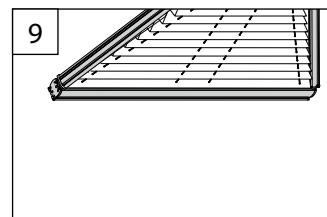
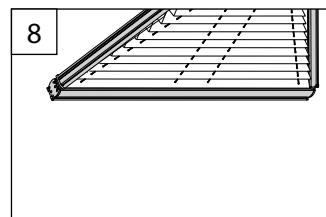
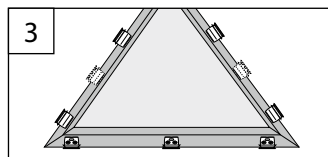
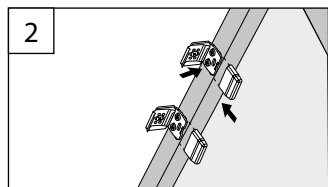
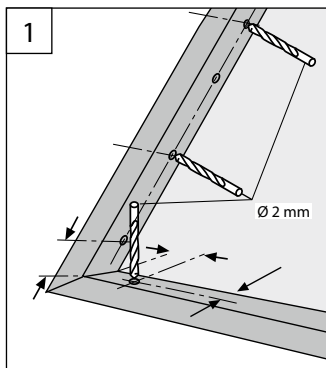

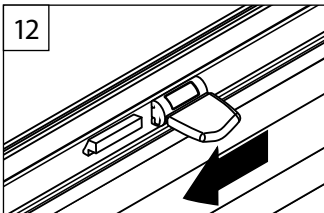

B Demontage

Dismantling – Démontage

DECKENCLIP

CEILING CLIP – CLIP PLAFOND

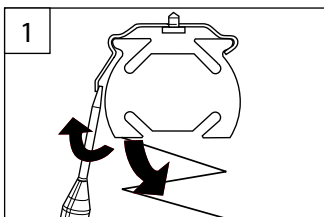

C Bedienung

Operation – Manipulation

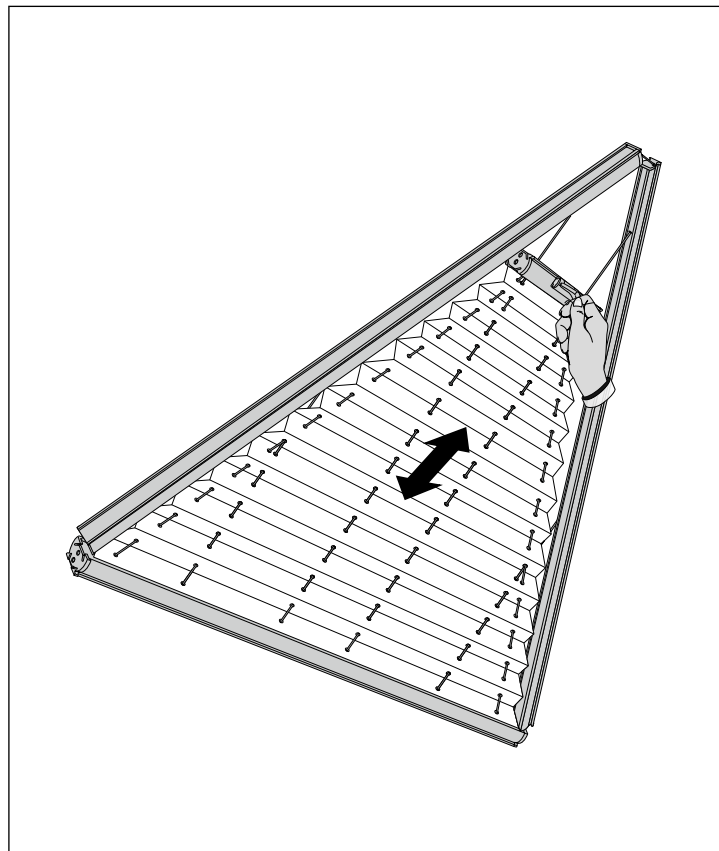

5

6