

5

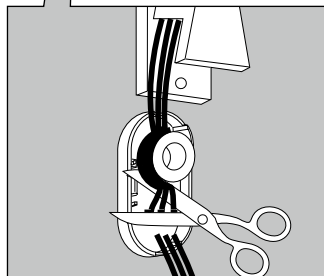

6

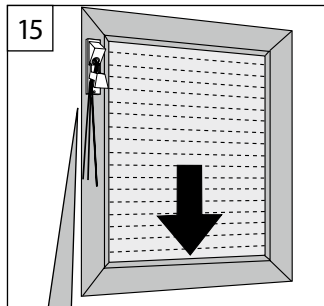
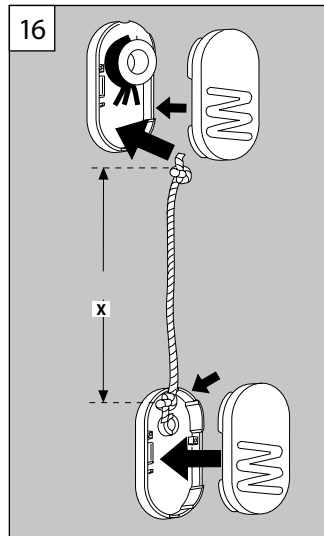

10 / 2014

technische Änderungen bleiben vorbehalten

subject to technical change  
sous réserve de modifications techniques

7

 Plissee  
Plated blinds – Stores plissés

**F1, F3**  
für Verbundfenster  
for composite windows - pour fenêtres composite

Montage- und  
Bedienanleitung

Assembly and operating instructions  
Notice de montage et mode d'emploi

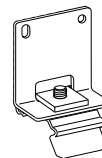

# Montage

Fixation – Montage

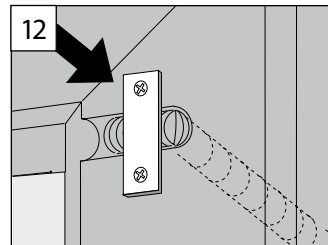
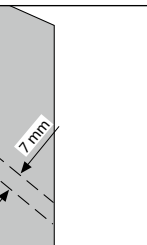
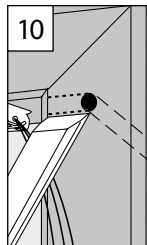
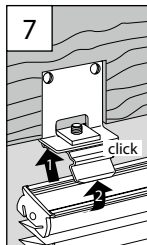
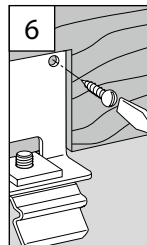
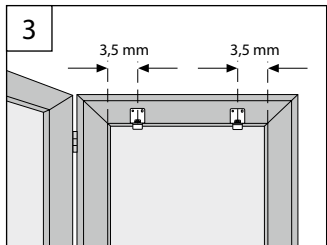
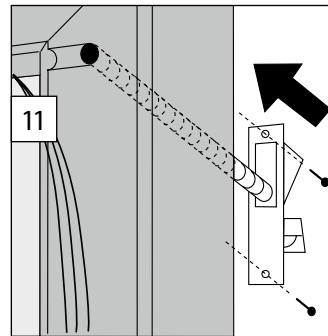
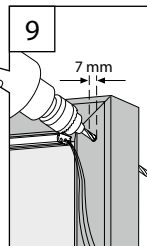
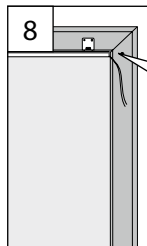
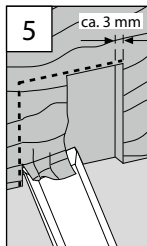
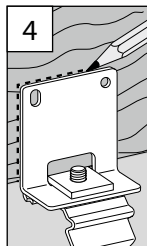
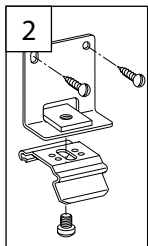
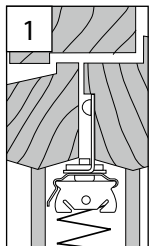

1

2

3

4