



| ASSEMBLY & PROGRAMMING INSTRUCTION





SINGLE REMOTE CONTROL

MULTI REMOTE CONTROL

different operation for the eROLLO DR (double roller blind) see user manual

TECHNOLOGY FROM FLORIDA
CONFIGURED IN GERMANY

CONTENT

- 4 ASSEMBLY INSTRUCTION
- 6 PROGRAMMING INSTRUCTION
- 8 MAINTENANCE
- 9 ALL-ROUND CAREFREE PACKAGE

eROLLO | ASSEMBLY INSTRUCTIONS

INSTALLATION OF eROLLO & eROLLO DESIGN

Please note: The eROLLO was especially adapted on the commanded mounting version and thus it's not allowed to change anything. Its only possible to switch from a ceiling fixation with clip to a wall fixation with brackets. Furthermore you can only switch from wall fixation with clip to a ceiling fixation with brackets.

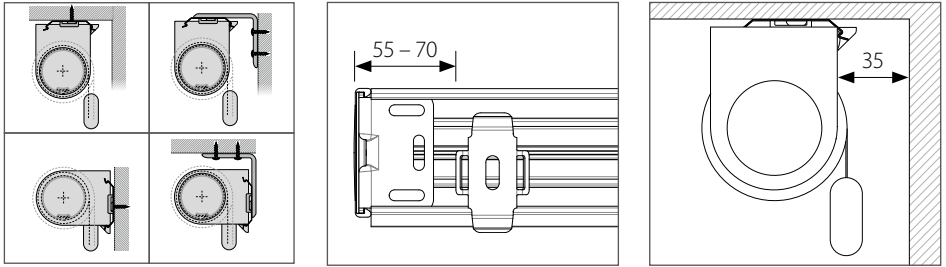

Fix the both outer brackets on the ceiling or wall, with a distance of 55 -70 mm to the end of the carrier section profile. Place further brackets in regular distances. For ceiling fixation without brackets please respect the necessary distance to the wall.

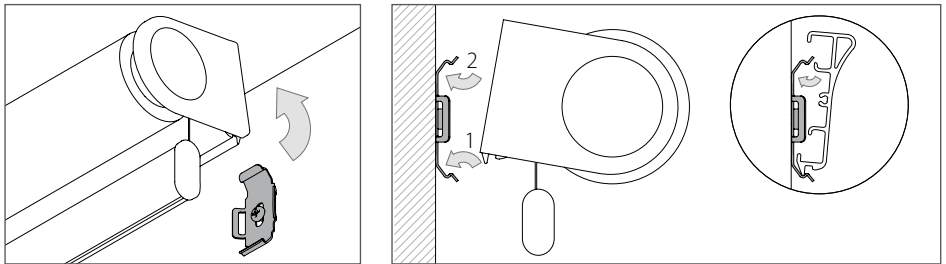

Tilt the eROLLO forwards, put the carrier section profile into the lower part of the brackets and click it backwards into the brackets. Alternatively you could insert the profile on the top first and then click it into the bottom (only if there's enough space above).

DISMANTLING OF eROLLO & eROLLO DESIGN

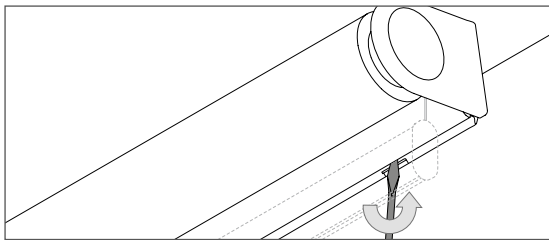

Use a flat screwdriver for the dismantling. Put it between the carrier section profile and clip and loosen the connection by turning the screwdriver.

INSTALLATION OF eROLLO CASSETTE

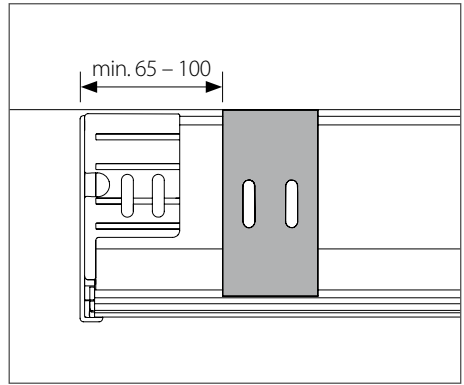
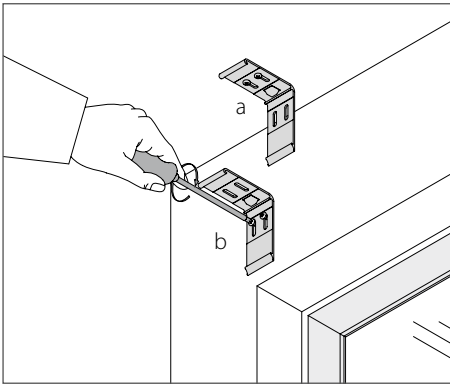

Fix the both outer brackets on the ceiling (a) or wall (b), with a minimum distance of 65 mm to the end of the cassette. Place further brackets in regular distances.

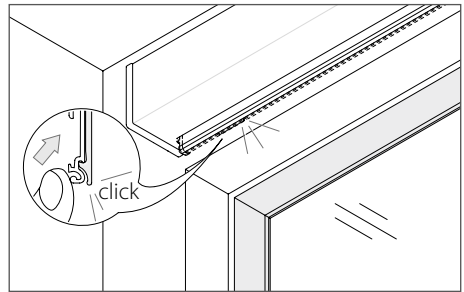
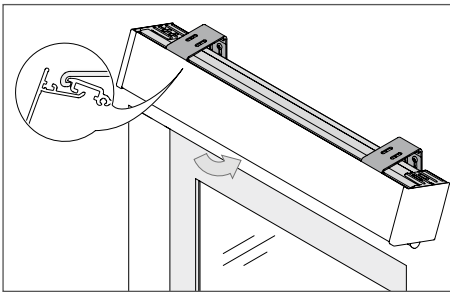

Put the cassette from the front into the brackets and click it backwards into the brackets. Push the cassette up until it clicks into the brackets.

DISMANTLING OF eROLLO CASSETTE

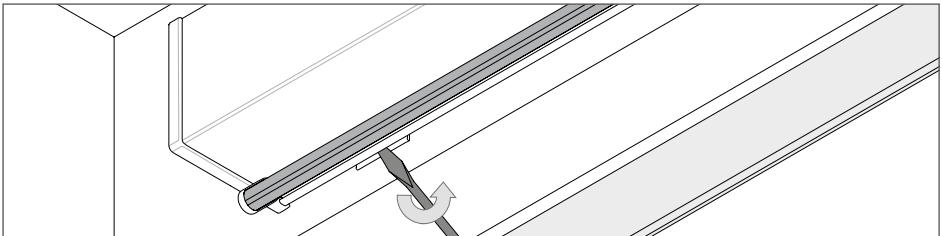

Use a flat screwdriver for the dismantling. Put it between the cassette and clip and loosen the connection by turning the screwdriver.

ADVICE

The following program steps are only required to change standard settings!

UPPER END POSITION

How can I adjust a new upper end position?

The upper end position is configured in the factory. The eROLLO will approach the hard stop (end limit). Afterwards it moves a little bit back to relieve the fabric.

How can I adjust a new intermediate position?

Intermediate stages at 25 %, 50 % and 75% are configured as standard. You can change the intermediate stages for all or separate eROLLOs into individual positions. Only eROLLOs where step 3 is executed will switch into the learn mode to learn the new positions. The other eROLLOs will move according to the pushed button, but they won't be adjusted.

1. Press the 25%, 50% or 75 % button shortly, depending on which one you would like to change. The eROLLO moves into the corresponding position.
2. Press the down button for approx. 8 seconds until the eROLLO moves up and down shortly.

expert advice: You should carry out step 3 within 30 seconds. Otherwise the eROLLO will switch back to the normal mode.

3. Pull by hand on the bottom profile for at least 10-15 cm.
expert advice: The eROLLO is now in the learn mode and won't react when pushing the down button. However, if the roller blind still reacts, restart with step 1.
4. Push the up button, bring the eROLLO above the new and requested intermediate position and stop the eROLLO by pushing the down button.
expert advice: If the new adjusted end position is lower than the previous end position, you can skip step 4.

5. Pull the bottom profile of the eROLLO to the new and requested intermediate position. A fine adjustment can be made by turning the tube.

6. Now push the corresponding 25%, 50% or 75% button for approx. 8 seconds, until the eROLLO moves up automatically.

expert advice: The eROLLO which was in the learn mode and moves up now for reference, won't react on commands from the remote control until it reaches the hard stop. A drive without hindrance is important! The new end position is adjusted.

How can I adjust a new intermediate position?

Intermediate stages at 25 %, 50 % and 75% are configured as standard. You can change the intermediate stages for all or separate eROLLOs into individual positions. Only eROLLOs where step 3 is executed will switch into the learn mode to learn the new positions. The other eROLLOs will move according to the pushed button, but they won't be adjusted.

1. Press the 25%, 50% or 75 % button shortly, depending on which one you would like to change. The eROLLO moves into the corresponding position.
2. Press the down button for approx. 8 seconds until the eROLLO moves up and down shortly.
expert advice: You should carry out step 3 within 30 seconds. Otherwise the eROLLO will switch back to the normal mode.
3. Pull by hand on the bottom profile for at least 10-15 cm.
expert advice: The eROLLO is now in the learn mode and won't react when pushing the down button. But if the roller blind still reacts, restart with step 1.
4. Push the up button, bring the eROLLO above the new and requested intermediate position and stop the eROLLO by pushing the down button.
expert advice: If the new adjusted end position is lower than the previous end position, you can skip step 4.
5. Pull the bottom profile of the eROLLO to the new and requested intermediate position. A fine adjustment can be made by turning the tube.
6. Now push the corresponding 25%, 50% or 75% button for approx. 8 seconds, until the eROLLO moves up automatically.
expert advice: The eROLLO which was in the learn mode and moves up now for reference, won't react on commands from the remote control until it reaches the hard stop. A drive without hindrance is important! The new end position is adjusted.

LOWER END POSITION

How can I adjust a new lower end position?

You have several eROLLOs on one channel of the remote control, but only want to adjust one?

Only eROLLOs where step 3 is executed will switch into the learn mode to learn the new positions. The other eROLLOs will move according to the pushed button, but they won't be adjusted.

1. Press the down button shortly and move to the lower (current) end position.
2. Press the down button for approx. 8 seconds until the eROLLO moves up and down shortly.
expert advice: You have to carry out step 3 within 30 seconds. Otherwise the eROLLO will switch back to the normal mode.
3. Push by hand on the bottom profile for at least 10-15 cm.
expert advice: The eROLLO is now in the learn mode and won't react when you push the down button. But if the roller blind still reacts, restart with step 1.
4. Push the up button, bring the eROLLO above the new and requested end position and stop the eROLLO by pushing the down button.
Please note: If the new adjusted end position is lower than the previous end position, you can skip step 4.
5. Pull the bottom profile of the eROLLO to the new and requested end position. A fine adjustment can be made by turning the tube.
6. Now push the down button for approx. 8 seconds, until the eROLLO moves up automatically.
expert advice: The eROLLO which was in the learn mode and moves up now for reference, won't react on commands from the remote control until it reaches the hard stop. A movement without hindrance is important! The new end position is adjusted!

How can I program a new remote control? | How can I add a remote control?**Use a programmed remote control (possibility 1)**

1. Press the up button shortly and move the roller blind into the upper end position.
2. After the roller blind stopped at the upper end position, push the up button for approx. 10 seconds until the roller blind moves down automatically (2nd response).
3. Release the up button.
4. The roller blind moves to the 75% position (or rather to the lowest and client-specific position). Restart with step 1 if the roller blind doesn't move to the 75% position.
5. Pull by hand on the bottom profile for at least 15 cm.
6. Choose, if necessary, the channel of your multi remote control.
7. Push the up button on your remote control, which should be added, for approx. 8 seconds until the roller blind moves. The roller blind will completely move up and leave the learn mode.

Restart/ battery change mode (possibility 2)**Without a programmed remote control**

Follow the steps of the battery change to interrupt the voltage

1. Pull the roller blind above the lower end position.
2. The roller blind moves back to the lower end position.
3. Pull the roller blind again 15 cm above the lower end position.
4. The roller blind moves to the 75% position
5. Now, you can pull the roller blind down until you can see the battery box.
6. Remove the battery box cover and the first battery. Wait for approx. 10 seconds.
7. Reinsert the battery and the battery box cover. The roller blind is now for one minute in the learn mode.
8. Choose, if necessary, the channel of your multi remote control.
9. Push the up button of the remote, which should be programmed, for approx. 8 seconds, until the roller blind moves automatically up.
10. The remote control is now programmed and the roller blind has left the learn mode.

REMOTE CONTROL

How can I reset a remote control? | How can I delete a remote control?

1. Push the up button on the remote control, which has to be deleted, and move the roller blind to the upper end position.
2. Push the up button for at least 10 seconds (2nd response, see overview on page 8) after the blind has reached the upper end position.
3. Release the up button.
4. The roller blind moves to the 75% position (or rather to the lowest and client-specific position). Restart with step 1 if the roller blind doesn't move to the 75% position.
5. Pull by hand on the bottom profile for at least 10-15 cm.
6. Push and hold the down button of the remote control, which has to be deleted, for approx. 5 seconds until the eROLLO will start to move up. The remote control is now reset.

BACK TO FACTORY SETTINGS

How can I set the roller blind back to factory settings?

You have several eROLLOs on one channel of the remote control, but want to set back just one or not all blinds?

Only eROLLOs where step 3 is executed will be set back. The other eROLLOs will move according to the pushed button, but they won't be adjusted.

1. Move the roller blind with the programmed remote control to the upper end position.
2. Push the up button for approx. 6 seconds until the 3rd response (approx. 15 seconds, see overview on page 8).
3. Pull the roller blind down for at least 15 cm. The roller blind is now set back to factory settings. The roller blind is now for 1 minute in the learn mode.
4. Push the up button of the remote control, which has to be programmed, for approx. 8 seconds until the eROLLO moves up automatically.
5. Now please follow the program steps, „How can I adjust a new lower end position?“

BATTERY
CHANGE

How can the batteries be changed?

1. Remove the end caps and the front blind of the cassette (see below). Pull the eROLLO shortly over the lower end position and let it go again. The eROLLO moves back to the lower end position.
2. Pull the eROLLO again approx. 15 cm above the lower position. The eROLLO moves now to the 75% position (or rather to the lowest customer-specific position). Now you can pull down the eROLLO until you can see the battery box.
- 3 Remove the battery box cover and change the batteries.
We recommend: Battery LR20D for eROLLO, Art-No.: 622550306.
4. Put the battery box cover on a level and push any button of the remote control. The eRollo moves into the prevailing position.
5. Now, install the blind and the ends caps of the eROLLO cassette.

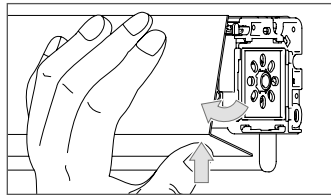
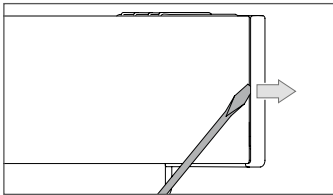

DISMANTLING
OF THE COVER
FOR eROLLO
CASSETTE

Put a flat screw driver between the blind and end cap and loosen the connection by turning it. Remove the end cap.

Now push the blind upwards and flip it forwards.

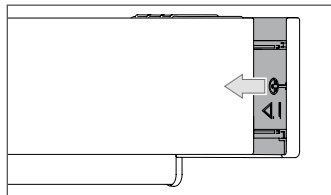
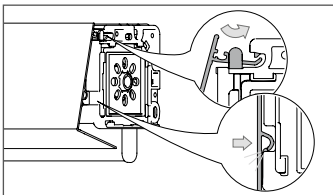

ASSEMBLY OF
THE COVER
FOR eROLLO
CASSETTE

Put the blind profile, as shown, into the brackets.

Push the end caps to click them into the brackets.

HAPPY, JUST LIKE THE FIRST DAY

Use the all-round carefree package and benefit from the free service-reminder for your eROLLO. Your eROLLO retailer will contact you after 36 months at the latest. Afterwards you can decide if you want to use the service.

The all-round carefree package includes:

- a test run of the eROLLO(s)
- a change of the roller blind batteries (recommended art.-no. 622 550 306)
- a change of the batteries of the remote control (recommended art.-no. 622 550 305)
- a check and if necessary an adjustment of the end positions
- a check and if necessary an adjustment of the intermediate positions
- a visual inspection of the fabric

ALL-ROUND CAREFREE PACKAGE

I want to use the service-reminder. My eROLLO retailer is allowed to contact me for presenting me an offer for the check and maintenance of my eROLLO.

I want to be informed by

- mail
- phone
- SMS
- e-mail

Salutation	_____		
Name, First name	_____		
Street / House number	_____		
Postcode / City	_____		
Mobile phone number	_____		
E-Mail	_____		
Date	_____	Signature	_____



eROLLO was awarded with the Innovation Award
Architecture Textile Object 2013. Furthermore
eROLLO was decorated with the label Interior
Innovation Award – Winner 2014.



www.erollo.de/en
a new room experience



This existing folder is copyrighted. Reprint and release (even in extracts) is only allowed after the previous approval by erfal. Changes and misapprehensions for the whole content are reserved.