

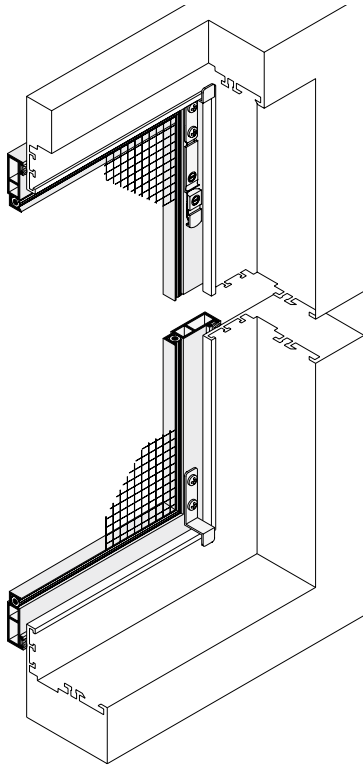

# List of products

## Insect screens

### FRAMED INSECT SCREEN FOR WINDOWS



### HINGED SCREEN FOR WINDOWS

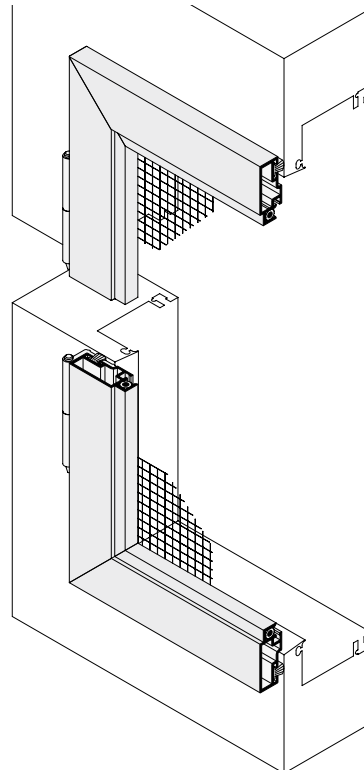

### HINGED SCREEN FOR DOORS

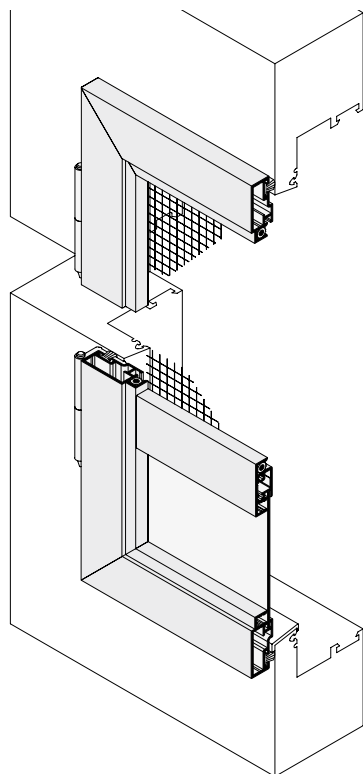

### ROLL-UP SCREEN FOR WINDOWS

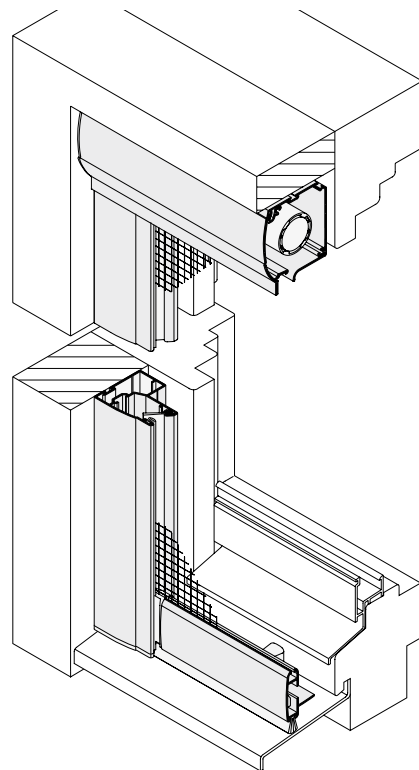

ROLL-UP SCREEN FOR DOORS

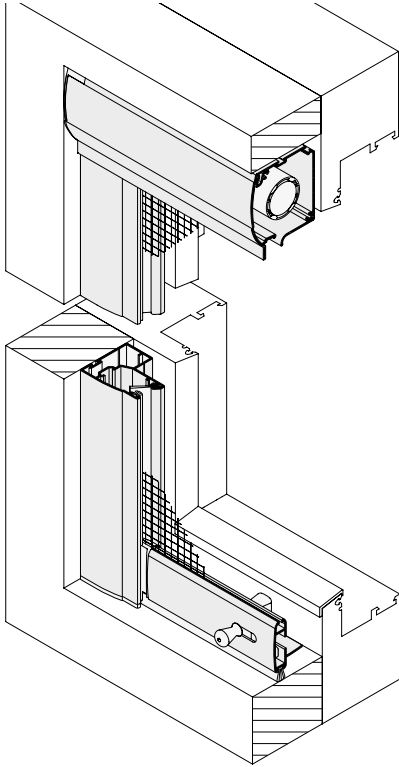

ROLL-AWAY SCREEN FOR DOORS

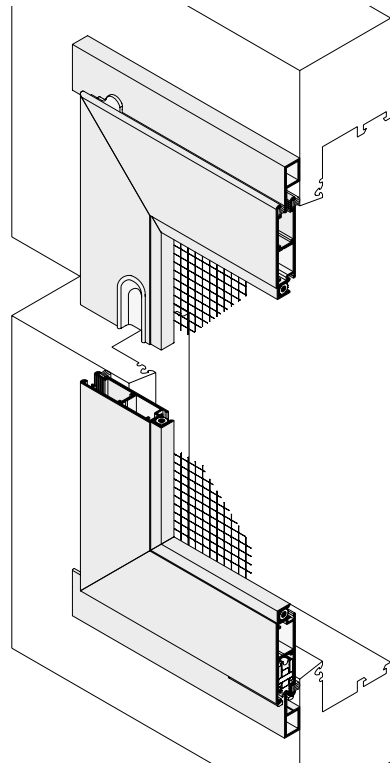

LIGHT WELL COVERS

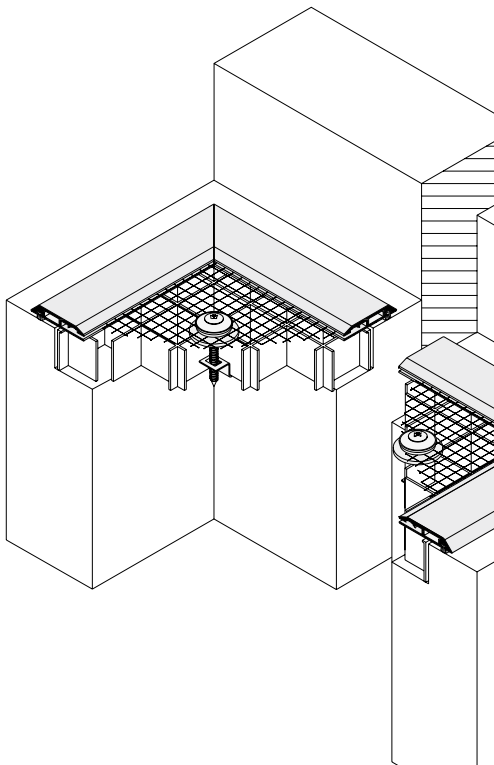

ELECTRIC ROLL-UP SCREENS FOR WINDOWS AND DOORS

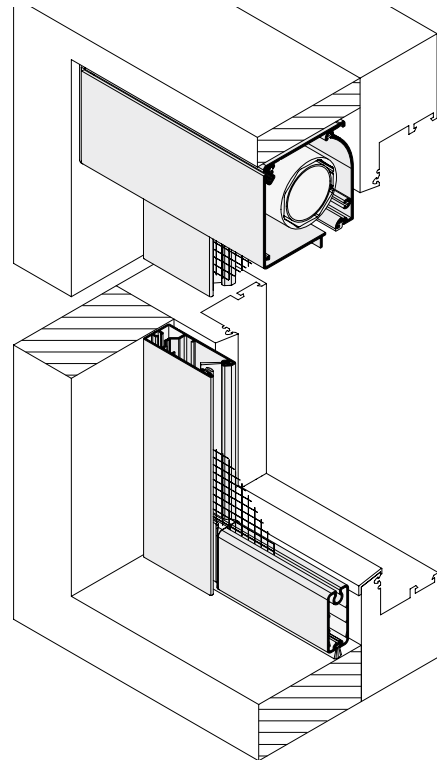

# Framed insect screen for windows

Insect screens

## Framed screen SP2 spring-supported (Variant SP2/1 shown)

### WITH SCREW PLATES

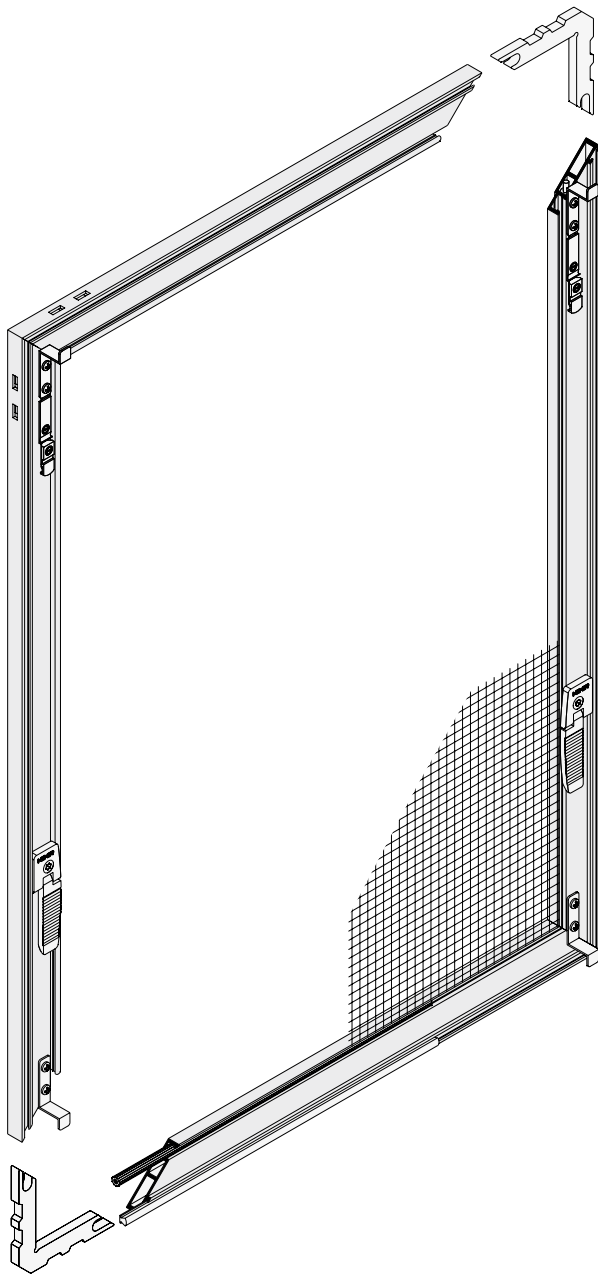

### FIXATION: SPRING-LOADED PLATE

The upper spring holder presses the stainless steel plate against the cover frame rebate. This ensures that the framed screen fits tight and does not rattle in the window.

The framed screen can be secured in addition with a locking device at the spring holder.

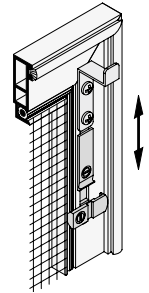

### SEALING

The framed screen has a PP brush pile seal inside towards the cover frame. Various brush sizes can compensate unevenness, e.g. frame offset etc.

The PP brush pile seal also protects the window against scratches and prevents rattling in strong winds.

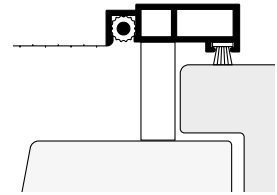

### HANDLE

The internal hinged handle is made of a special plastic material that is extremely resistant to breaking.

The easy-to-use handle is available in 6 standard colours, is delivered colour-matched to the frame colour and it is not visible from the outside.

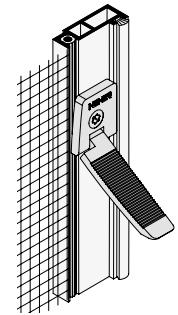

### EXTENSION BRACKET

The extension bracket is used to bridge even cover frame rebates up to 44 mm.

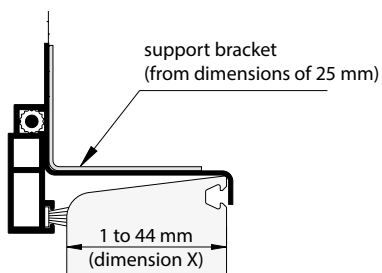

### SIDE RETENTION

The framed screens of the SP2 series can be equipped with a side retention if required.

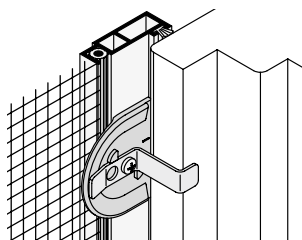

### BAR FROM 1500 mm HEIGHT/WIDTH

From a height/width of 1500 mm, a bar can be used for mesh reinforcement that does not split the mesh.

If requested, the bar need not be installed with a height/width of 1500 mm to 1900 mm (series SP4/...).

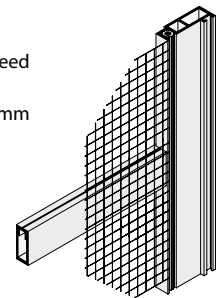

## Hinged screens for windows DF3 and DF4 (Variant DF3/1 shown)

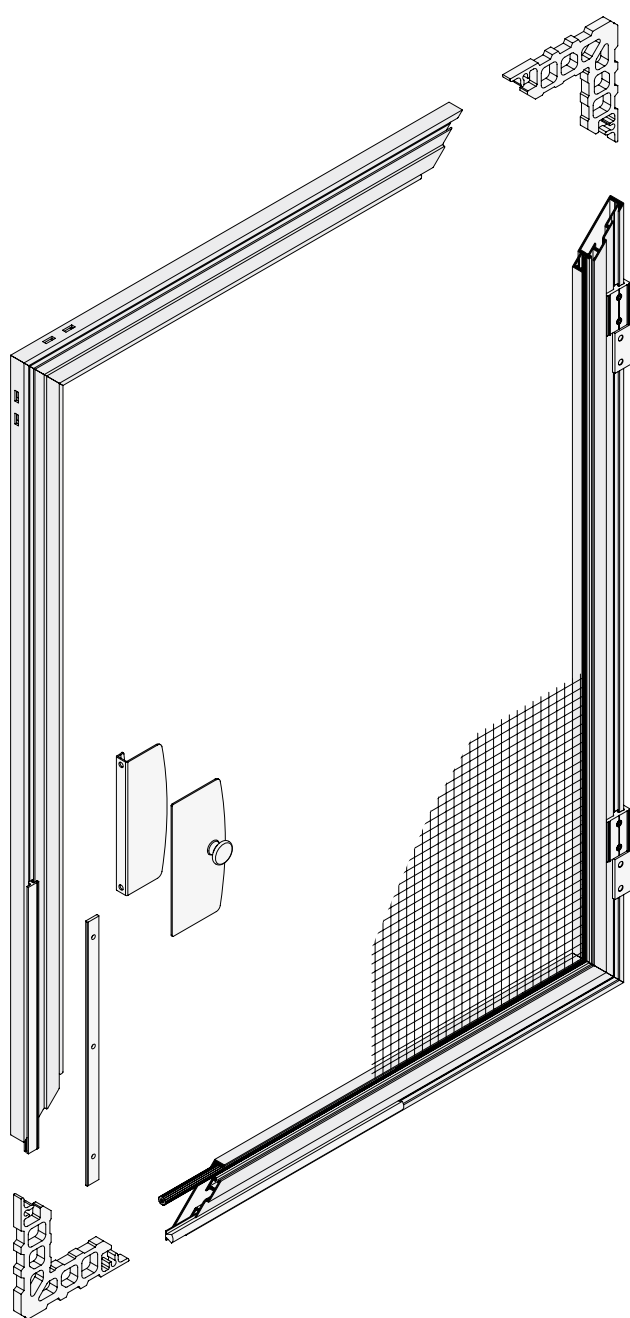

### SCREEN PROFILES

The extra sturdy curved contour profile 10 35 02 is used for the hinged screen of the DF3 series.

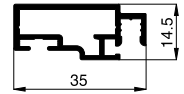

The profile 10 36 04 that is also very robust is used for the hinged screen of the DF4 series.

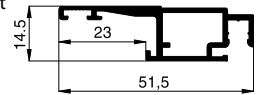

### CLOSURE

A concealed double-sided magnetic strip (with frame for mounting) or a magnetic strip with a stainless steel strip as a counterpart (without frame) is used as a closure. This ensures that the hinged screen will fit tightly even on slightly distorted windows.

A self-adhesive magnetic strip can also be used instead of the counterpart stainless steel strip.

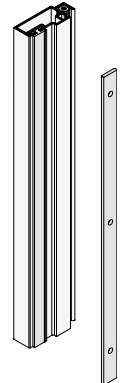

### HINGED SCREEN FOR OPENING TO THE INSIDE

The mounting frame 10 35 21 can be used to install hinged screens opening to the inside.

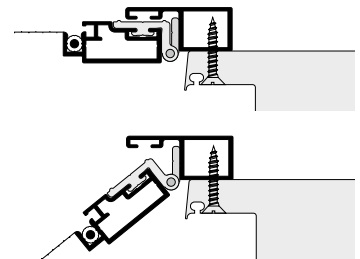

### THE MOUNTING FRAME 10 35 31

If the installation space is cramped so that neither the hinged screen without mounting frame nor the hinged screen with mounting frame 10 35 21 can be used, the hinged screen with mounting frame 10 35 31 must be used. It is installed from outside to the reveal or directly on the roller blind guide channel and there it can be sealed.

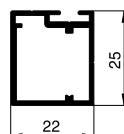

### THE MOUNTING FRAME 10 35 21

The mounting frame 10 35 21 has a slim design so that it can even be installed between the window and the roller blind guide channel.

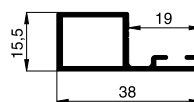

### BAR FROM 1800 mm HEIGHT/WIDTH

A bar that splits the mesh is used for reinforcement from 1800 mm height/width.

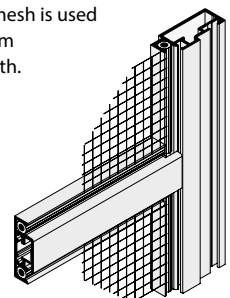

# Hinged screen for doors

Insect screens

## Hinged screen for doors DT3 (Variant DT3/5 shown)

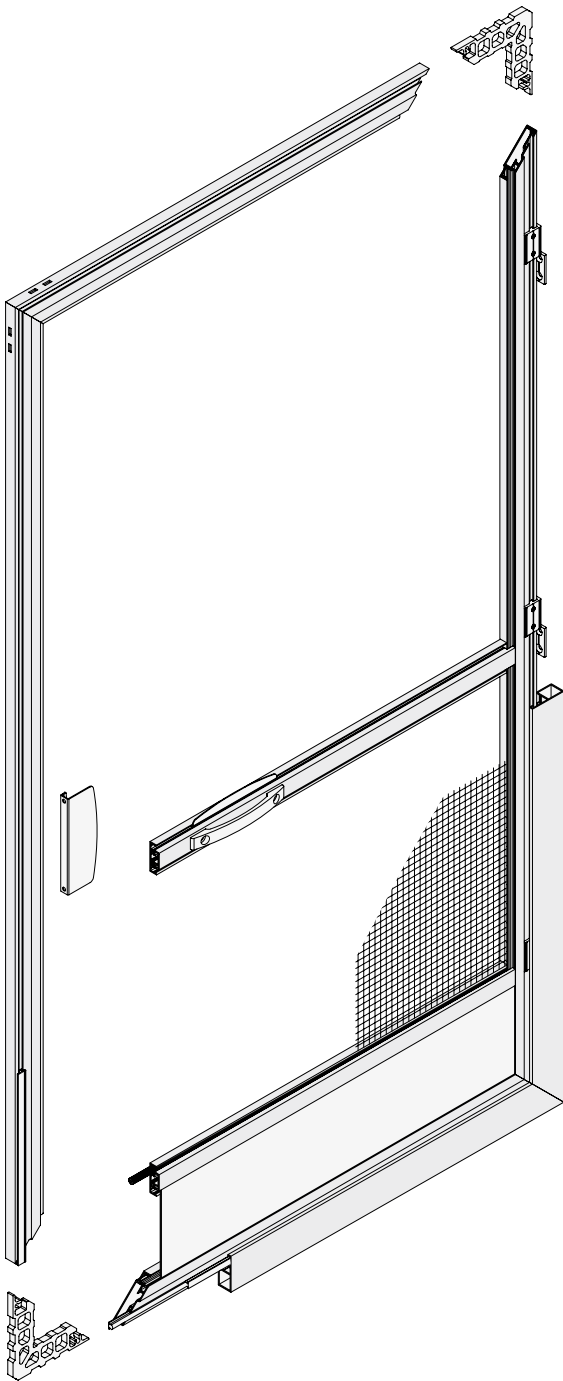

### SLIDING CLOSURE

The hinged screens of the DT3 series can be equipped with a sliding closure if required.

It can be operated from the inside, outside or both.

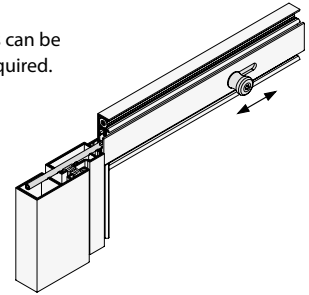

### CAT AND DOG FLAP

The hinged screens for doors of the DT3 series can be equipped with a cat or dog flap whose installation measures do not change.



### MOUNTING FRAME

Several mounting frames are available for the hinged screen of the DT3 series.

This allows installing the hinged screen either between the door and roller blind guide channel or directly to the reveal even under difficult installation conditions.

The hinged screen can also be opened to the inside if desired.

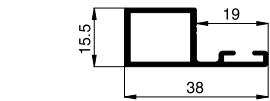

10 35 21

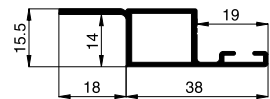

10 35 24

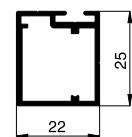

10 35 31

### HINGED SCREEN WITH BRUSH PILES

All hinged screens of the DT3 series are also available with brush piles. Magnetic effect is obtained through block magnets on the front side that are installed inside the respective profiles or in a special magnet holder.

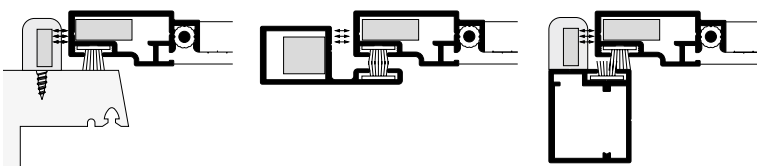

### DOOR CLOSER

On request, the hinged screen door can also be equipped with a door closer with a gas-pressure cylinder or with a door closer with a torsion bar spring.



## Roll-up screens for windows RF4 (Variant RF4/2 shown)

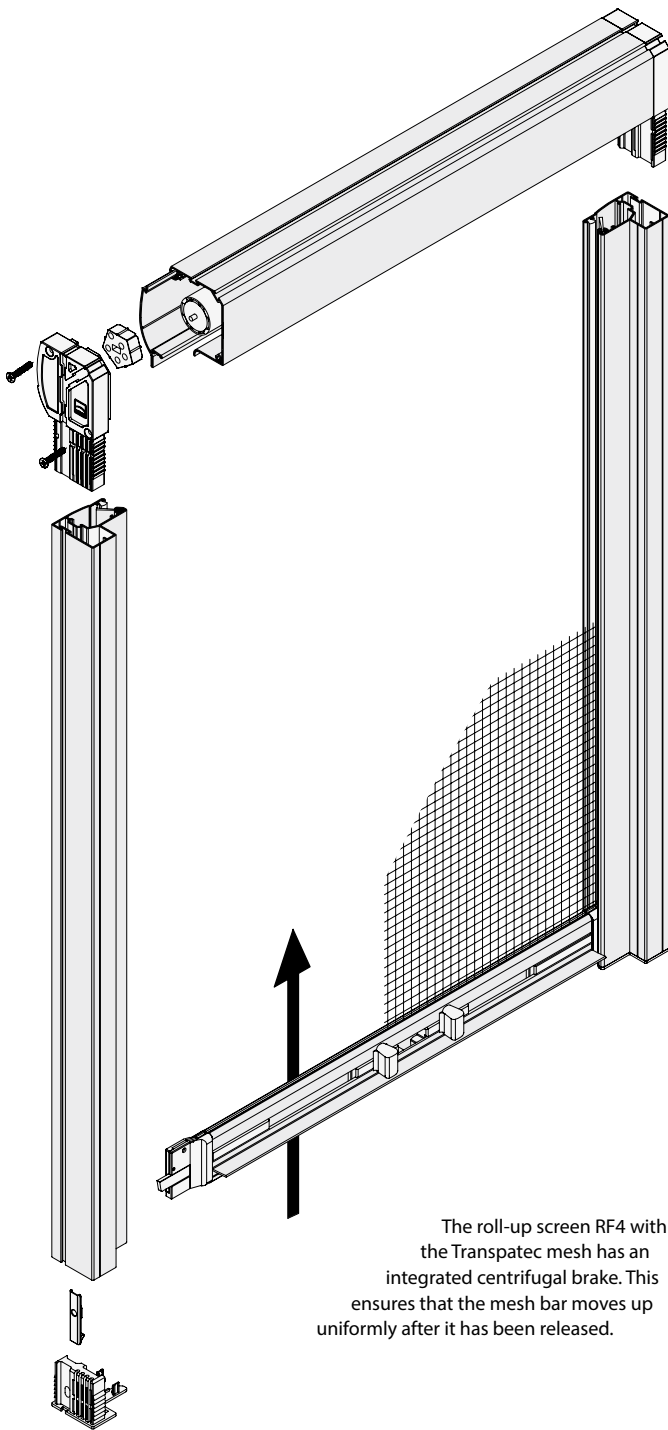

The roll-up screen RF4 with the Transpatec mesh has an integrated centrifugal brake. This ensures that the mesh bar moves up uniformly after it has been released.

### MESH UNWINDING EDGE

The mesh unwinding edge ensures that the fabric is always thoroughly stretched and insects cannot slip through at the mesh roll.

Additionally, the central position of the mesh provides space for the handle (easy operation even under cramped installation conditions).

### HINGED SERVICE COVER

The cover of the screen roll case can be easily folded out even in its installed position.

This allows removing the mesh tube or readjusting the spring with a special pretensioner.

The height adjustment disk is used to adjust the tilt of the mesh tube (compensation of inaccuracies that occurred during installation).

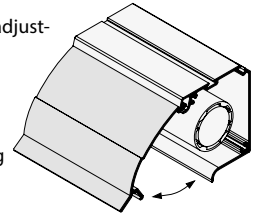

### HANDLE WITH INTEGRATED LOCK

The handle is designed for one-hand operation with horizontal spring lock, the counterpart of which can be adjusted in height.

This technology is very robust and tolerates slight inaccuracies in installation (guiding rails are not parallel).

In addition, no space for downward motion is required for unlocking (mounting on window sill).

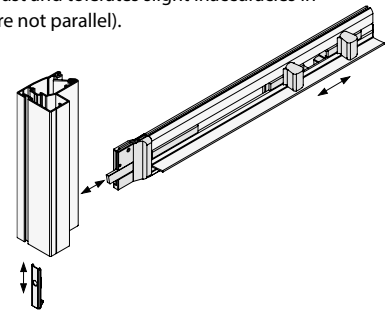

### LATERAL GUIDING RAILS

The extra strong guiding rail has separate installation pockets. This makes installation considerably easier.

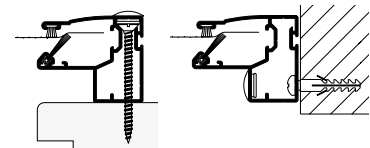

### ADDITIONAL LOCKING POINT

Another lock counterpart provides for another locking point.

This prevents that the mesh roll accidentally moves outside reach. Alternatively, a control rod or pull cord can be used.

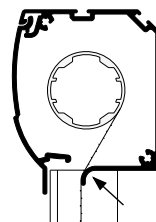

# Roller blind insect screens for doors

Insect screens

## Roll-up screens for doors RT4

(Variant RT4/2 shown)

### HINGED SERVICE COVER

The cover of the screen roll case can be easily folded out even in its installed position.

This allows removing the mesh tube or readjusting the spring force with a special pretensioner.

The height adjustment disk is used to adjust the tilt of the mesh tube (compensation of inaccuracies that occurred during installation).

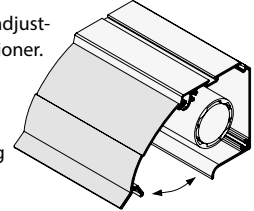

### HANDLE WITH INTEGRATED LOCK

The handle is designed for one-hand operation inside or outside with horizontal spring lock whose counterpart can be adjusted in height. This technology is very robust and tolerates slight inaccuracies in installation (guiding rails are not parallel).

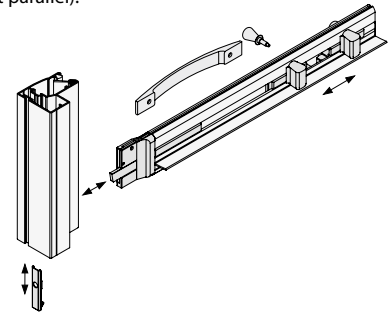

### SIDE GUIDING RAILS

The extra strong guiding rail has separate installation pockets. This makes installation considerably easier.

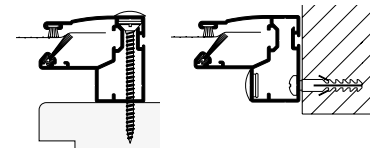

The roll-up screen RT4 with the Transpatec mesh has an integrated centrifugal brake.

This ensures that the screen bar retracts when released.

### MESH UNWINDING EDGE

The mesh unwinding edge ensures that the mesh is always thoroughly stretched and insects cannot slip through at the mesh roll.

Additionally, the central position of the mesh provides space for the handle (easy operation even under cramped installation conditions).

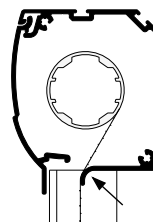



## Sliding screens ST3

(Variant ST3/50 shown)

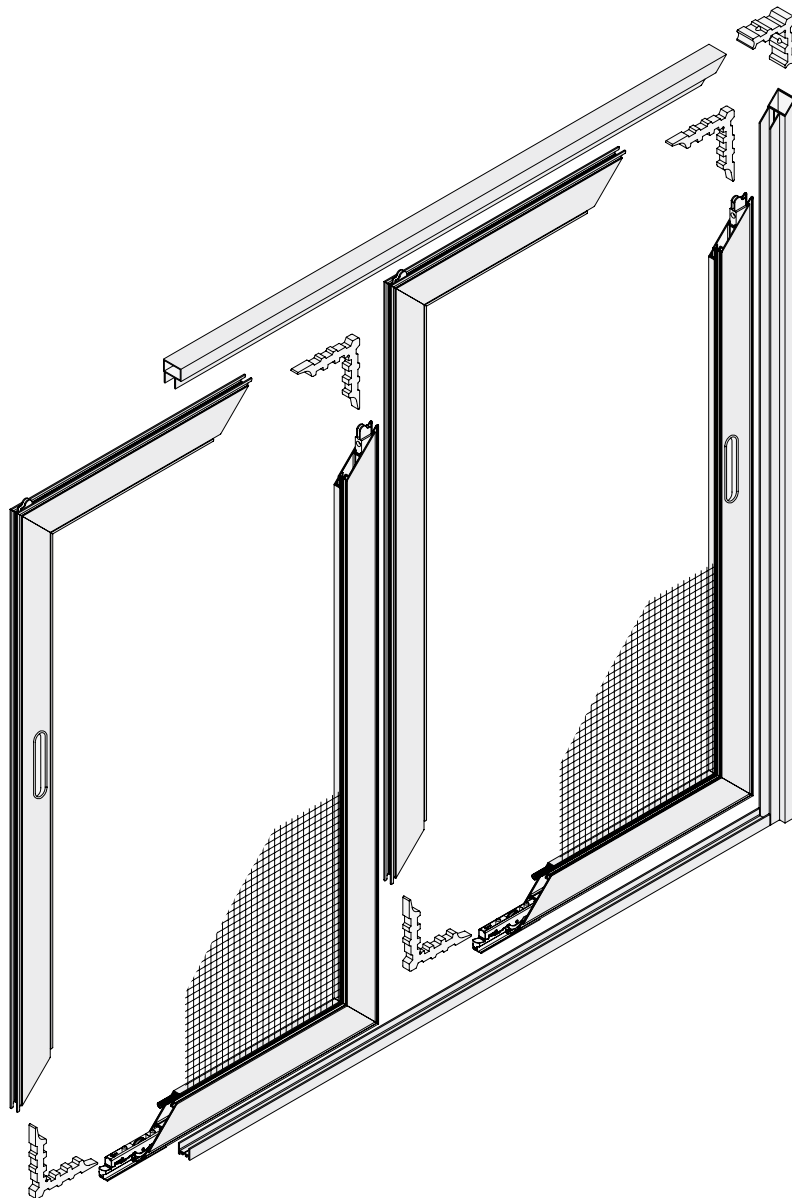

### HANDLE STRIP

The handle strip can be used as an alternative for the handle recess. This considerably increases the screen profile stability. It permits installation of roll-away screens up to 3.0 m high. Due to the continuous handle the sliding screen can be operated easily at any height making them ideal for children. The slim track rail profile allows 14 mm installation depth.

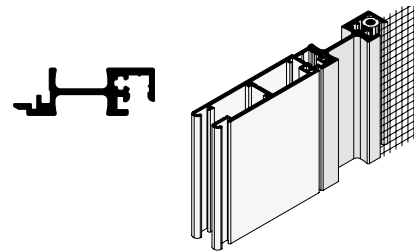

### FOOT OPERATION RECESS

A foot operation recess can be installed in connection with a footplate on both sides of the sliding screen so that it can be operated from both sides. This allows opening and closing a sliding screen with your foot.

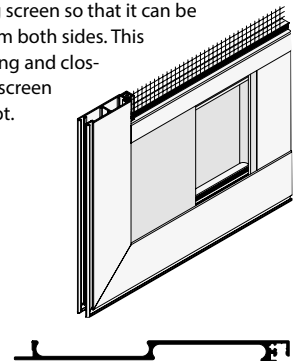

### HEIGHT-ADJUSTABLE ROLL WITH TRACK RAIL GUIDE

To compensate installation tolerances, the sliding screen can be adjusted with the help of a height-adjustable roll. Up to 8 mm offset of the screen joint can be compensated.

The track rail guiding integrated in the roll prevents "jumping" of the screen in which the track rail strip gets jammed between the roll and the screen profile.

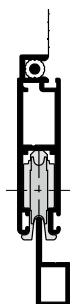

### SPRING-SUPPORTED ROLL-AWAY SCREEN GUIDE WITH LOCK

The spring-supported sliding screen guide and the lock that is mounted to the top guiding rail hold the sliding screen in its limit position.

This retaining force can be adjusted steplessly.

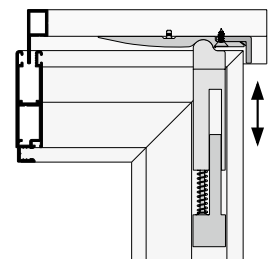

# Sliding screens for doors

Insect screens

## Sliding screens ST4

(Variant ST4/50 shown)

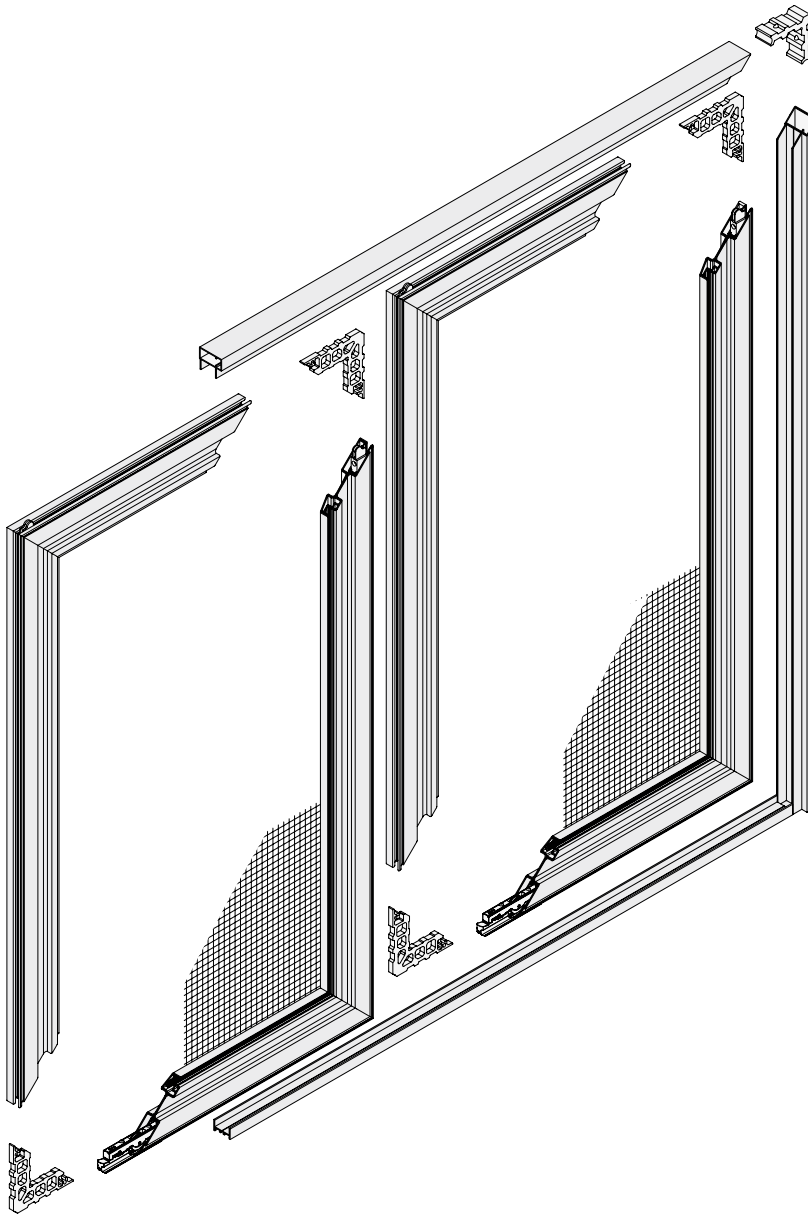

### INTEGRATED HANDLE STRIP

A handle strip is integrated in the sliding screen. The corner channel installed at the side of the trail rack adds to the high stability of the profile, in lateral and longitudinal direction.

This allows installation of roll-away screens up to 3.5 m high.

Due to the continuous handle the sliding screen can be operated easily at any height making them ideal for children.

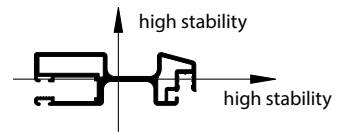

### FOOT OPERATION RECESS

A foot operation recess can be installed in connection with a footplate on both sides of the sliding screen so that it can be operated from both sides.

This allows opening and closing a sliding screen with your foot.

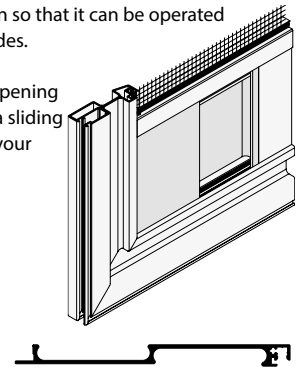

### HEIGHT-ADJUSTABLE ROLL WITH TRACK RAIL GUIDE

To compensate installation tolerances, the sliding screen can be adjusted with the help of a height-adjustable roll. Up to 8 mm offset of the screen joint can be compensated.

The track rail guiding integrated in the roll prevents "jumping" of the screen in which the track rail strip gets jammed between the roll and the screen profile.

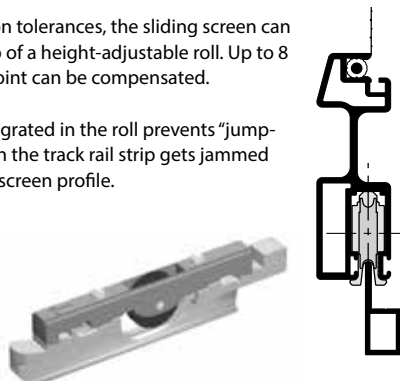

### SPRING-SUPPORTED ROLL-AWAY SCREEN GUIDE WITH LOCK

The spring-supported sliding screen guide and the lock that is mounted to the top guiding rail hold the roll-away screen in its limit position.

This retaining force can be adjusted steplessly.

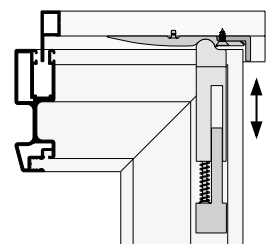

**Electric roll-up screens ER1** (Variant ER1/2 shown)

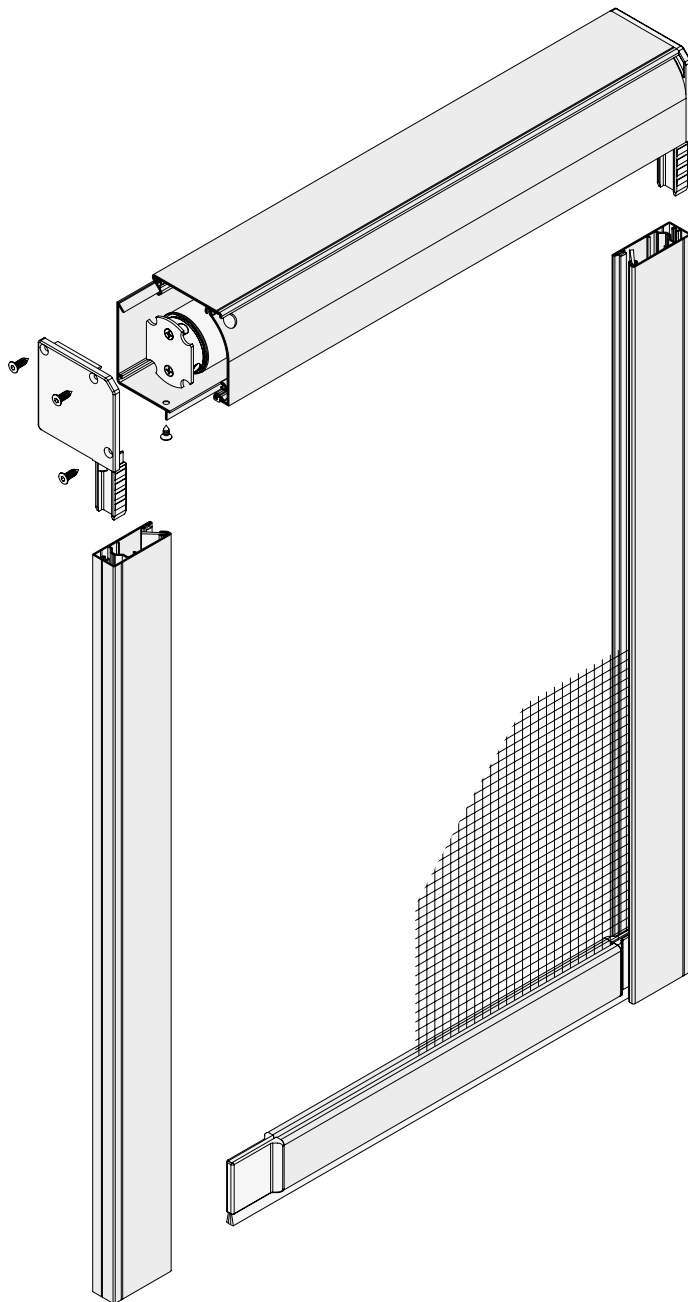

**HINGED SERVICE COVER**

The cover of the screen roll case can be easily folded out even in its installed position.

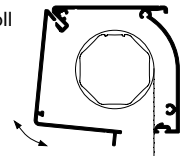

When the roller blind screen case is installed in a recess, a split cover is used.

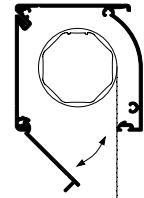

With both cover types, the mesh roll can be removed when the case is installed. This allows easy maintenance of the mesh and motor.

**HIGH-SPEED MOTOR WITH SAFETY FEATURES**

The high-speed motor (70 rpm) is available with and without radio control. The motor is equipped with a safety feature for hitting an obstacle in the downward movement. That means when the mesh bar hits an obstacle the motor stops, reverses a bit (override function) and stops again. The motor excels by its silent operation and soft deceleration.

**SIDE GUIDING RAILS**

The mesh is guided by the brush pile system that has been tried and tested for many years now. With 20 mm the guide channel is still slim and has a separate installation pocket.

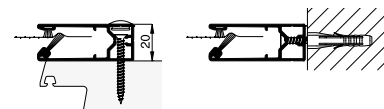

**MECHANICAL TYPE**

The electric roll-up screen ER1 can also be equipped with a spring-supported tube.

This allows using the ER1 screen both for windows and doors either operated electrically (tube motor) or mechanically (spring-supported tube). Both versions can be retrofitted.

Therefore, this universal roller blind screen system is easy to plan.

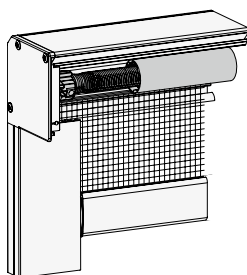

**EASY INSTALLATION**

The mesh roll case is self-supporting on the guiding rails up to 1500 mm width. For large units or separate case installation a mounting plate is provided where the case is hooked in and can be screwed (without drilling).

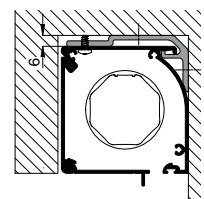

# Light well covers

Insect screens

## Light well covers LI1 LiSA (Variant LI1/1 shown)

### PROFILE / MESH FIXATION

The frame profile, only 6.5 mm high, with special reinforcement has a 45° chamfer to the outside. This edge design reduces the risk of stumbling.

The mesh is fixed with the profile. Thus it is fixed permanently without distorting the profile.

### BAR THAT SPLITS MESH

On request, a bar can be installed that splits the mesh.

From a width (depth) of 2000 mm such a bar is recommended as otherwise the mesh could rattle.

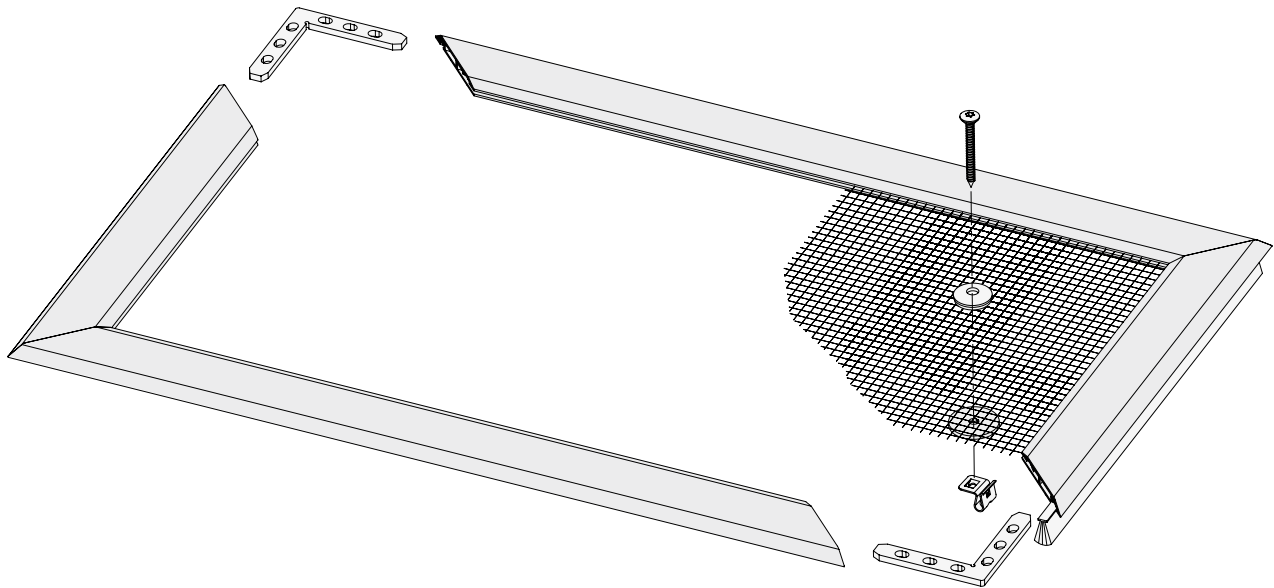
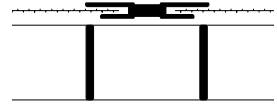

### LIGHT WELL GRATING LOCK

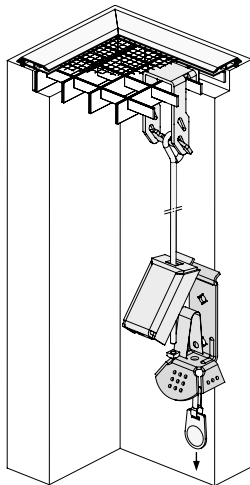

On request, the light well with the integrated cover LiSA can be equipped with a special light well grating lock system.

The grating lock can be unlocked easily with a cotter. An integrated spring mechanism opens the suspended lock automatically so that it can be removed easily.

The Neher light well grating lock is also suitable for escape routes.

### FIXATION

The standard light well grating lock LiSA is screwed to the grating with a locknut from top.

On request, the grating can be locked concealed through bolting from the bottom.

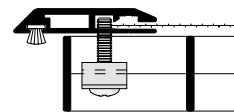

### WALL SEALING

Sealing towards the wall is done with the profile 10 33 07. This profile can be provided with brush piles 15 mm (standard) to 30 mm.

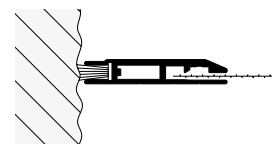

## Available mesh

| Type of mesh                             | Design/colour    | Product group |    |    |    |    |       |    |    |
|--|------------------|---------------|----|----|----|----|-------|----|----|
|  |                  | SP            | DF | DT | RF | RT | ER    | ST | LI |
| Transpatec                               | TTA - anthracite | •             | •  | •  | •  | •  | •     | •  |    |
| Glass fibre fabric                       | FA - anthracite  | •             | •  | •  | •  | •  | •     | •  |    |
|  | FG - grey        | •             | •  | •  | •  | •  | •     | •  |    |
| Transpatec fine-mesh fabric              | TFP - anthracite | •             | •  | •  | •  | •  | •     | •  |    |
| Polltec pollen protection fabric         | PIA - anthracite | •             | •  | •  |    |    |       | •  |    |
| HF electro-smog shielding mesh           | EG - anthr./grey | •             | •  | •  | •  |    |       | •  |    |
| Polyester fabric                         | PA - anthracite  | •             | •  | •  |    |    |       | •  |    |
|  | PG - grey        | •             | •  | •  |    |    |       | •  |    |
| Polyester fabric electric roll-up screen | PAE - anthracite |               |    |    |    |    | • (1) |    |    |
| Sun protection glass fibre fabric        | IS - anthracite  |               |    |    | •  |    |       |    |    |
| Aluminium mesh                           | AA - anthracite  | •             | •  | •  |    |    |       | •  |    |
| Stainless steel mesh V2A                 | V2 - grey        | •             | •  | •  |    |    |       | •  |    |
| Stainless steel mesh V4A                 | V4 - grey        | •             | •  | •  |    |    |       | •  |    |
| Stainless steel mesh for light well V2A  | V2 - grey        |               |    |    |    |    |       |    | •  |
| Expanded metal - aluminium               | SMA - anthracite |               |    |    |    |    |       |    | •  |
|  | SMG - grey       |               |    |    |    |    |       |    | •  |

(1) The polyester mesh PAE can only be used for the electrical roll-up screen ER2.



Refer to our catalogue of insect screen products for our whole range of products of insect screens.

